



Digital electronic wheel-balancer with adjustable LED display

Digital electronic wheel-balancer with adjustable LED display. Equipped with balancing programs for wheels with alu-rims, static and dynamic balancing program; balance optimization.

## Main Features



### Fast & Easy Split

Fast & Easy Split (FES) divides the counterweight needed to correct imbalance, based on the installation position behind the spokes of the aluminium rim. Requires a very simple, very quick operation without the need to enter...



### No Wheel Needed

"No Wheel Needed" (NWN) system for calibrating gauges. The gauge shaft or Sonar detector is positioned at a given distance from the fixed points established for the procedure, without the need for using sample wheels.



### Opposite Weight Function

Opposite weight function (OWF) positions the counterweight at the bottom of the aluminium rim (at 6:00), where manual installation of the weight is easier and more accessible. The function requires a very simple...



### Car

Suitable for car wheels



## Description

The balancer is supplied with a new concept wheel guard, pedal brake, wheel distance and diameter automatic measuring gauge, cones and quick clamping ring nut.

### Functions

- Automatic measuring of wheel diameter and distance;
- Automatic START and STOP;
- Pedal brake;
- Static and dynamic balancing;
- Huge combination of ALU programs;
- NWN system;
- Special ALU-S program;
- FES function;
- OPTIMATCH function;
- Self-diagnosis;
- Self-calibration;
- OPF function;
- Complete with cones and quick clamping ring nut;
- Complete with Wheel guard;
- Automatic measuring of wheel width by SONAR (LA) available as optional.

## Standard Features

Max. wheel weight	75 kg
Max. tyre diameter	1100 mm
Rim diameter	10"-30" / 255-765 mm
Rim width	1.5"-20" / 40-510 mm
Power supply	230V - 1ph - 50/60 Hz
Cycle time	4.7s (5 3/4 "x 14") 15 Kg
Balancing speed	< 100 rpm
Balancing precision	± 0.5g
Net weight	105 kg



Standard accessories

Standard accessories

Standard accessories

Standard accessories



**UNILUG** (9342855)  
Wheel clamping adaptor for wheels without central hole or with special flanging



9342856  
Kit of 5 quick-lock centering stud bolts for Unilug



9342860  
Set of 5 extra-long spherical nuts for Unilug



9342861  
Clamping cone with spacer for SUV and 4WD wheels; central hole diam. 122-174 mm



9342862  
Clamping cone with spacer for clamping wheels of LCVs and vans; central hole diam. 198-225 mm



9342863  
Special cone for clamping wheels from outside; central hole diam. 100-118 mm



9342867  
Spacer kit for clamping SUV or 4WD all terrain wheels, to prevent the wheel from touching wheelbalancer baseframe.



**QUICKPLATE** (9342864)  
Wheel clamping adaptor with flange and 4 centering stud bolts, for wheels with max. 4 lug holes



**QUICKPLATE** (9342865)  
Wheel clamping adaptor with flange and 5 centering stud bolts, for wheels with max. 5 lug holes



**QUICKPLATE** (9342866)  
Wheel clamping adaptor with flange and 6 centering stud bolts, for wheels with max. 6 lug holes



**RL** (9314901)  
RL protective sleeve for alloy rims.



**WBL81** (9437137)  
WBL81 wheel lift, for wheel easy positioning and centering on the shaft, without any effort for the operator.



**PROBIKE EKO KIT** (9341191)  
Clamping adaptor for motorcycle wheels. Complete with 14 mm diam. shaft. and Quick Fix quick clamping device

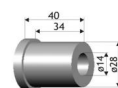

9342850  
Set of 28 mm centering rings for Probike Eco Kit with 14 mm diam. shaft



9342851  
19 mm diam. shaft with complete set of centering rings, adaptors and Quick Fix quick clamping device, for ProBike Eco



**PROFI KIT** (9342852)  
Set of special adaptors for 19 mm diam. shaft on ProBike Eco



9342853  
10 mm diam. shaft with adaptors, for ProBike Eco



**LA** (9336362)  
LA sonar for automatic measuring of wheel width.



Scan QR code to go to product web page



**Giuliano Automotive Equipment (Suzhou) CO.,Ltd**

NO 8 Jinsheng Road

SIP Suzhou (Jiangsu)

P.R.China

+86 0512 69368611

+86 0512 69367919

<https://www.giuliano.cn>

